

Building Sketch

Client				
Property Address 144 Quail Haven Dr				
City	Troutman	County	State	NC Zip Code 28166
Lender				

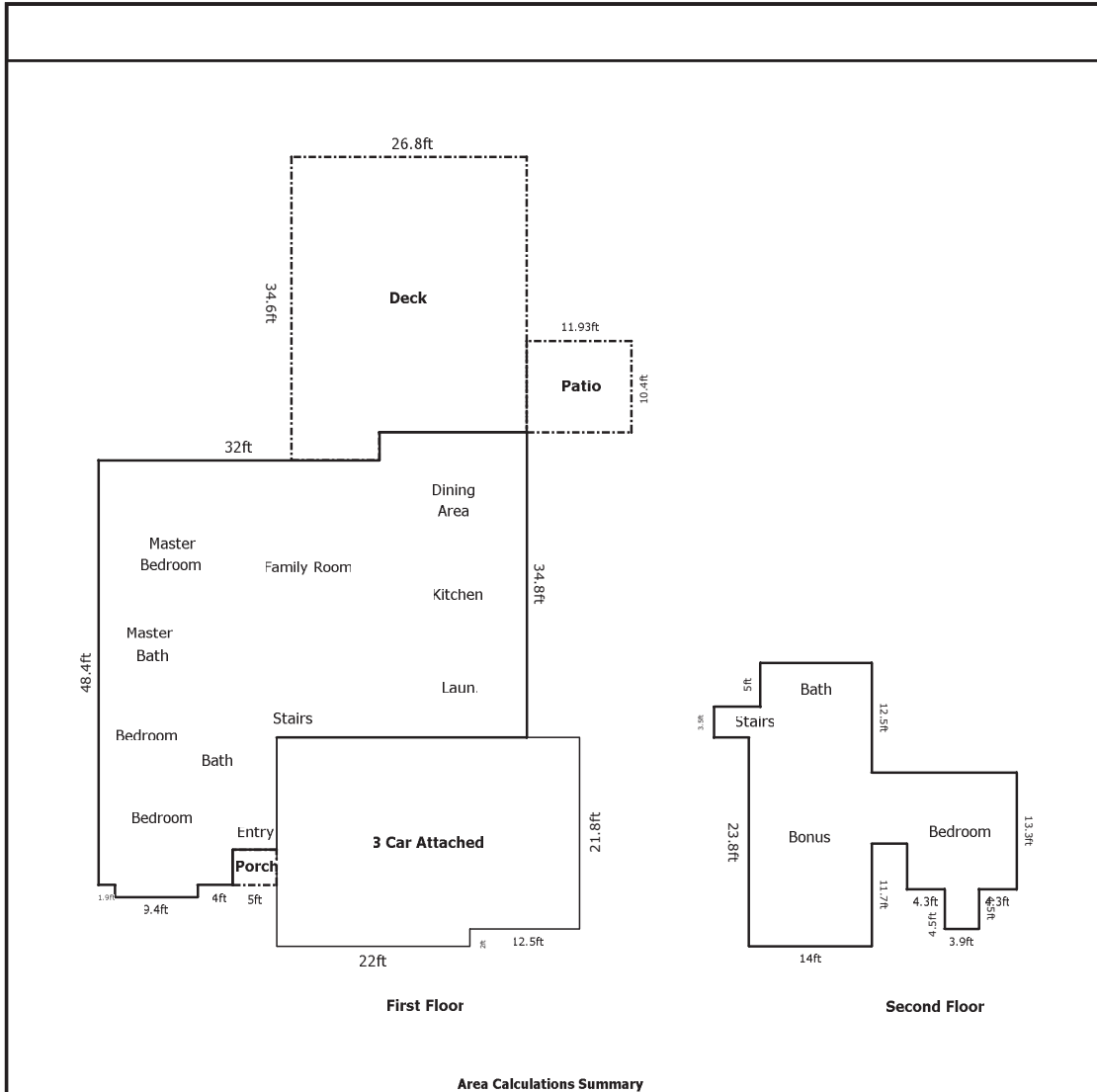

Area Calculations Summary

Living Area	Calculation Details		
First Floor	1930 Sq ft	9.4 × 1.4	= 13.16
		34.8 × 16.8	= 584.64
		32 × 31.6	= 1011.2
		16.8 × 15.3	= 257.04
		5 × 12.8	= 64
Second Floor	675.9 Sq ft	3.9 × 4.5	= 17.55
		13.3 × 12.5	= 166.25
		8.1 × 4	= 32.4
		32.3 × 12.7	= 410.21
		27.3 × 1.3	= 35.49
		3.5 × 4	= 14
Total Living Area (Rounded):	2606 Sq ft		
Non-living Area			
3 Car Attached	796.1 Sq ft	23.8 × 22	= 523.6
		12.5 × 21.8	= 272.5
Patio	124.1 Sq ft	10.4 × 11.9286	= 124.05744
Deck	873.5 Sq ft	26.8 × 31.4	= 841.52
		10 × 3.2	= 32
Porch	20 Sq ft	4 × 5	= 20