

Building Sketch

Borrower/Client				
Property Address 203 Windemere Isle				
City	Statesville	County	State	NC Zip Code
Lender				

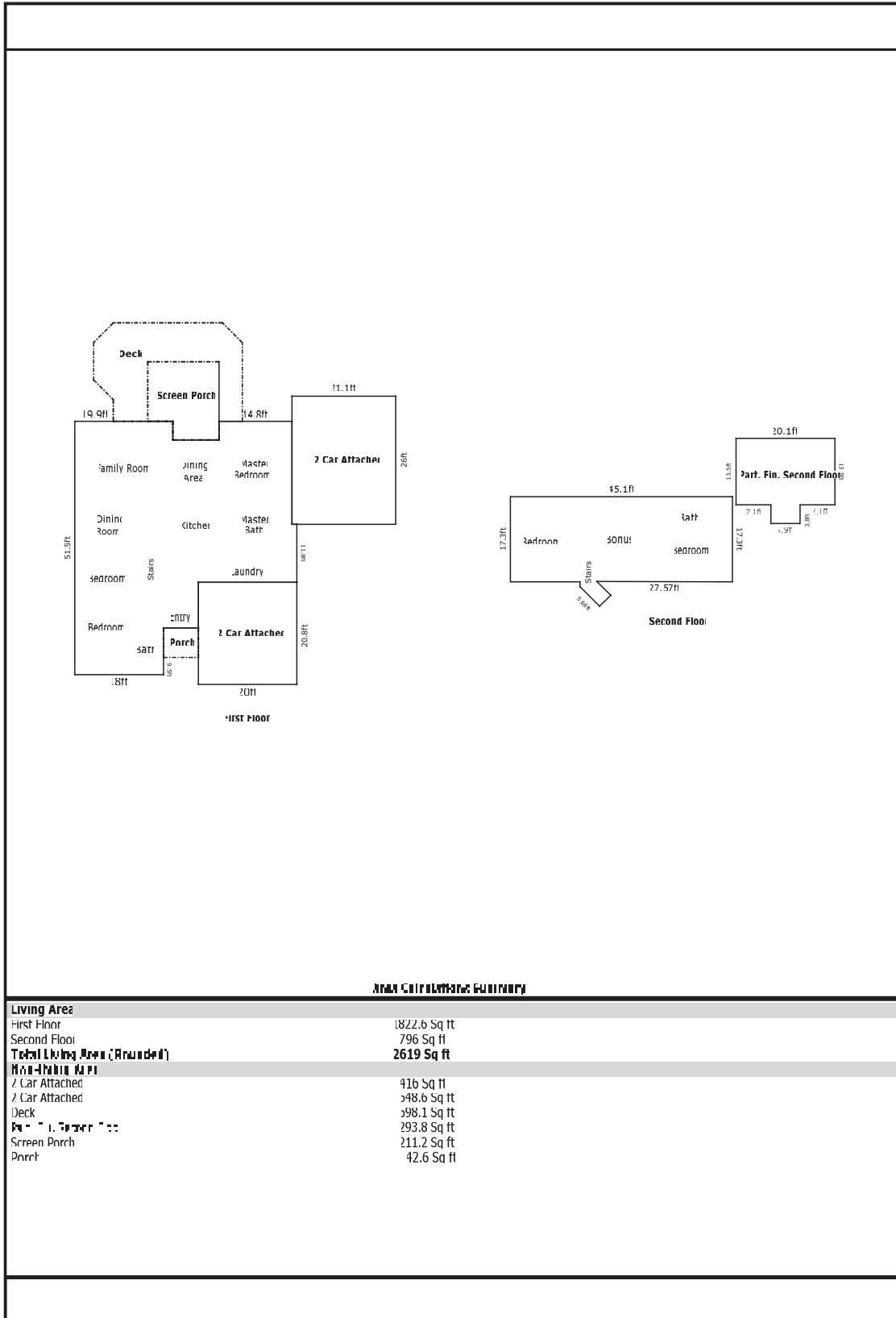

AREA CALCULATIONS SUMMARY

Living Area	
First Floor	1822.6 Sq ft
Second Floor	796 Sq ft
Total Living Area (Rounded)	2619 Sq ft
Non-Living Area	
2 Car Attached	416 Sq ft
2 Car Attached	488.6 Sq ft
Deck	398.1 Sq ft
Screen Porch	293.8 Sq ft
Porch	211.2 Sq ft
Porch	42.6 Sq ft

Building Sketch

Borrower/Client				
Property Address 203 Windemere Isle				
City	Statesville	County	State	NC Zip Code
Lender				

Area Calculations Summary			
Living Area		Calculations Details	
First Floor	1822.6 Sq ft	18 x 9.5 =	171
		42 x 19.5 =	835.8
		5.2 x 9.3 =	48.36
		25.7 x 11.8 =	303.26
		20.9 x 14.8 =	309.32
		17.1 x 9.4 =	160.74
Second Floor	796 Sq ft	45.1 x 17.2088 =	776.11688
		0.0912 x 14.1 =	1.28592
		2.4141 x 10.017 =	24.2150816
		16.5 x 10.017 x 2.015 =	339.535872
		2.4569 x 3.2 =	7.86208
		0.5 x 3.2 x 3.2 =	5.12
		16.5 x 5.2 x 5.017 x 2.015 =	1.25699592
Total Living Area (Rounded)	2619 Sq ft		
Non-Living Area			
1 Car Attached	416 Sq ft	20 x 20.8 =	416
2 Car Attached	548.6 Sq ft	26 x 21.1 =	548.6
Deck	398.1 Sq ft	0.5 x 4 x 4 =	8
		0.5 x 4 x 4 =	8
		7.6 x 4 =	30.4
		9.4 x 3.8 =	35.72
		20 x 22.2 =	444
		4 x 16 =	64
		0.5 x 4 x 4 =	8
Front Porch	293.8 Sq ft	20.1 x 13.5 =	271.35
		3.8 x 5.9 =	22.42
Screen Porch	111.2 Sq ft	14.5 x 12.1 =	175.45
		9.4 x 3.8 =	35.72
Porch	42.6 Sq ft	7.1 x 6 =	42.6