

### Building Sketch

Client	Lisa Crabtree				
Property Address	498 Hicks Creek Rd				
City	Troutman	County	Iredell	State	NC
Client	Lisa Crabtree	Zip Code	28166-8669		

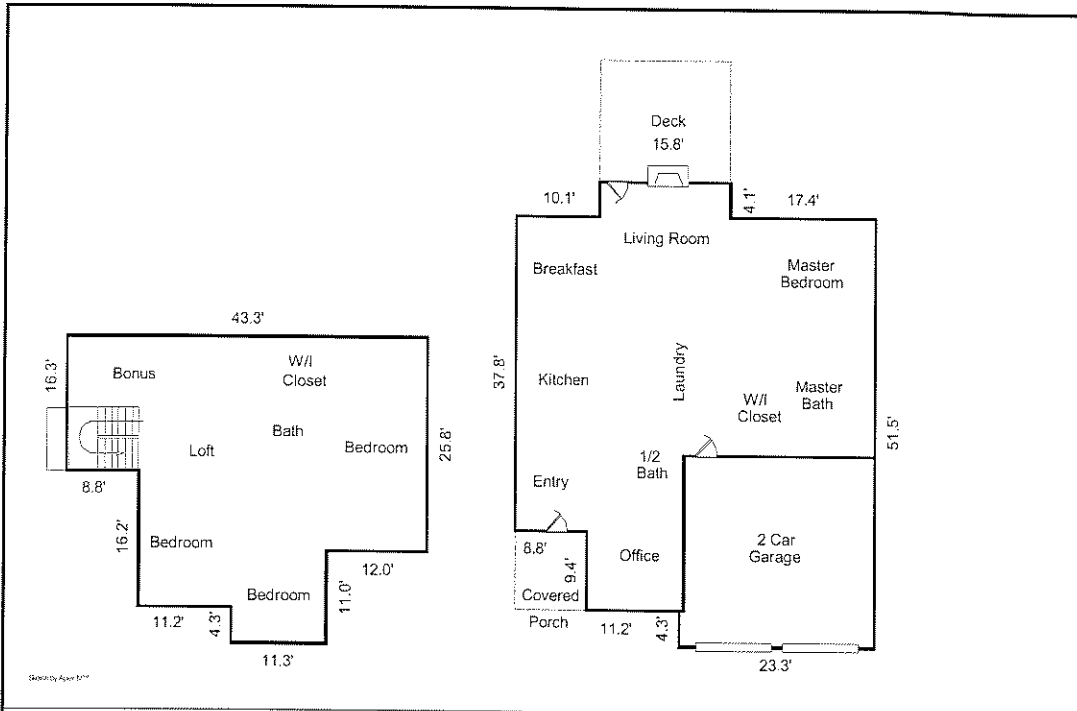

Comments

AREA CALCULATIONS SUMMARY			
Code	Description	Net Size	Net Totals
GLA1	First Floor	1604.0	1604.0
GLA2	Second Floor	1232.9	1232.9
P/P	Covered Porch	82.7	
	Deck	229.1	311.8
GAR	Garage	522.0	522.0
Net LIVABLE Area (Rounded)			2837

LIVING AREA BREAKDOWN		
	Breakdown	Subtotals
First Floor		
	4.1 x 15.8	64.8
	34.5 x 47.2	1628.4
	8.8 x 37.8	332.6
	4.3 x 23.3	100.2
Second Floor		
	22.5 x 32.5	731.3
	4.3 x 11.3	48.6
	8.8 x 16.3	143.4
	12.0 x 25.8	309.6
Garage		-522.0
8 Items (Rounded)		2837